

**Dorset County Council**



**Wildlife and Countryside Act 1981**

**Dorset County Council  
County of Dorset Definitive Map and Statement of Rights of Way**

**Dorset County Council (A Footpath from Verlands Road to the A353 Preston Road,  
Weymouth at Preston)  
Definitive Map and Statement Modification Order 2017**

This Order is made by Dorset County Council under section 53(2)(b) of the Wildlife and Countryside Act 1981 ("the Act") because it appears to that authority that the County of Dorset Definitive Map and Statement require modification in consequence of the occurrence of an event specified in section 53(3)(c)(i) namely, that a right of way which is not shown in the map and statement subsists or is reasonably alleged to subsist over land in the area to which the map relates and section 53(3)(c)(iii) namely, that any other particulars contained in the map and statement require modification.

The authority have consulted with every local authority whose area includes the land to which the order relates. The Dorset County Council hereby order that:

1. For the purposes of this Order the relevant date is 22 September 2017.
2. The County of Dorset Definitive Map and Statement shall be modified as described in Part I and Part II of the Schedule and shown on the map attached to the Order.
3. This Order shall take effect on the date it is confirmed and may be cited as the "Dorset County Council (A Footpath from Verlands Road to the A353 Preston Road, Weymouth at Preston) Definitive Map and Statement Modification Order 2017".

Dated this 10<sup>TH</sup> day of ~~NOVEMBER~~ 2017

THE COMMON SEAL OF THE  
DORSET COUNTY COUNCIL  
was fixed in the presence of:-

*Sarah Ann*

653/17

Authorised Signatory

The foregoing order is hereby confirmed

*Heidi Cruickshank* 27 SEP 2021

An Inspector appointed by The Secretary  
of State for Environment, Food and  
Rural Affairs

## SCHEDULE

(The points specified relate to the map attached to the Order and their positions are identified by national grid references)

### Part I

#### **Modification of definitive map Description of path to be added**

A Footpath to be added in Weymouth in the Weymouth and Portland Borough:  
(to be numbered *Footpath 158, Weymouth*)

- A – A1 – From its junction with the eastern end of Verlands Road, south of Pickwick at  
A2 – B – point A (SY 70728319), east along a compacted tarmac/stone/gravel surfaced  
C – D path, passing to the north of 30 Verlands Road to point A1 (SY 70738319)  
and continuing east along the path (via point A2 (SY 70768319)) to the field  
boundary at point B (SY 70808320). Continue east, entering the field and  
across a grass surfaced path, running parallel with the southern fence line to  
the field boundary at point C (SY 70928321). Turn east south east, down a hill  
(known as Winslow Hill) and across a field to its junction with Footpath 27 and  
the A353 Preston Road at point D (SY 71128317).  
The width varies: 6.25 metres at point A (SY 70728319), 7.8 metres at point  
A1 (SY 70738319), 3.7 metres at point A2 (SY 70768319), 3.6 metres at point  
B (SY 70808320), 2 metres at point C (SY 70928321), narrowing to 1.2  
metres at point D (SY 71128317). Limitation: Gate at point C (SY 70928321).

### Part II

#### **Modification of definitive statement Variation of particulars of path**

Footpath 158, Weymouth in the Weymouth and Portland Borough:

**Add:**

From: SY 70728319 To: SY 71128317

From its junction with the eastern end of Verlands Road, south of Pickwick, east along a compacted tarmac/stone/gravel surfaced path, passing to the north of 30 Verlands Road to SY 70738319 and continuing east along the path (via SY 70768319) to the field boundary at SY 70808320. Continue east, entering the field and across a grass surfaced path, running parallel with the southern fence line to the field boundary at SY 70928321. Turn east south east, down a hill (known as Winslow Hill) and across a field to its junction with Footpath 27 and the A353 Preston Road. The width varies: 6.25 metres at SY 70728319, 7.8 metres at SY 70738319, 3.7 metres at SY 70768319, 3.6 metres at SY 70808320, 2 metres at SY 70928321, narrowing to 1.2 metres at SY 71128317. Limitation: Gate at SY 70928321.

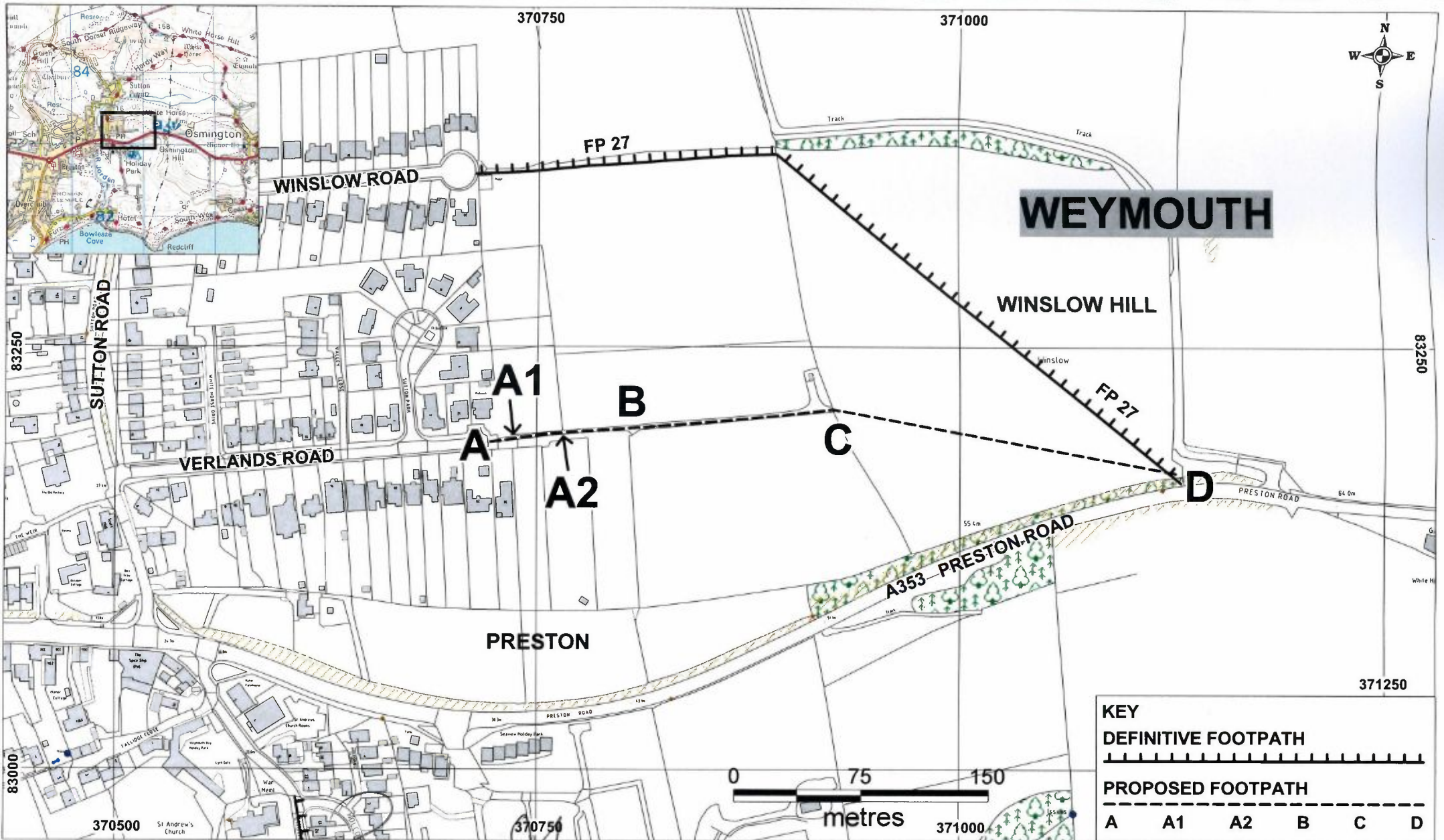

**DORSET COUNTY COUNCIL (A FOOTPATH AT WEYMOUTH, FROM VERLANDS ROAD TO A353 PRESTON ROAD, WEYMOUTH) DEFINITIVE MAP AND STATEMENT MODIFICATION ORDER 2017**

**GRID REFERENCES**

A	SY 70728319
A1	SY 70738319
A2	SY 70768319
B	SY 70808320
C	SY 70928321
D	SY 71128317

**Ref: 14/16/1**  
**Date: 8/06/2015**  
**Scale 1:3000**  
**Drawn By: ACWH**  
**Cent X: 370857**  
**Cent Y: 83204**

GEOGRAPHICAL INFORMATION SYSTEMS

**Dorset County Council**

© Crown copyright and database rights 2017 Ordnance Survey 100019790. You are permitted to use this data solely to enable you to respond to, or interact with, the organisation that provided you with the data. You are not permitted to copy, sub-licence, distribute or sell any of this data to third parties in any form. Aerial Photography © UKPerspectives 2002 © Geomapping 2005, 2009 & 2014